

QUANTITY: 3 off
 REFER TO LOCATION FOR LOCATION
 Powder coated 'Nalup' high grade quality Aluminium anodized frames and beadings complete with gaskets and seals. Colour to be selected.
 Tinted & Laminated 'Safety glass' 'Elior' to suite SANS strength and safety requirements, colour to be selected.
 Specialists to design, supply and install 'Nalup' Shofort Unit all to Architect's approval. Refer to Architectural Specifications for detail requirements.

QUANTITY: 3 off
 REFER TO LOCATION FOR LOCATION
 Powder coated 'Nalup' high grade quality Aluminium anodized frames and beadings complete with gaskets and seals. Colour to be selected.
 Tinted & Laminated 'Safety glass' 'Elior' to suite SANS strength and safety requirements, colour to be selected.
 Specialists to design, supply and install 'Nalup' Shofort Unit all to Architect's approval. Refer to Architectural Specifications for detail requirements.

QUANTITY: 1 off
 REFER TO LOCATION FOR LOCATION
 Powder coated 'Nalup' high grade quality Aluminium anodized frames and beadings complete with gaskets and seals. Colour to be selected.
 Tinted & Laminated 'Safety glass' 'Elior' to suite SANS strength and safety requirements, colour to be selected.
 Specialists to design, supply and install 'Nalup' Shofort Unit all to Architect's approval. Refer to Architectural Specifications for detail requirements.

QUANTITY: 6 off
 REFER TO LOCATION FOR LOCATION
 Powder coated 'Nalup' high grade quality Aluminium anodized frames and beadings complete with gaskets and seals. Colour to be selected.
 Tinted & Laminated 'Safety glass' 'Elior' to suite SANS strength and safety requirements, colour to be selected.
 Specialists to design, supply and install 'Nalup' Shofort Unit all to Architect's approval. Refer to Architectural Specifications for detail requirements.

QUANTITY: 1 off
 REFER TO LOCATION FOR LOCATION
 Powder coated 'Nalup' high grade quality Aluminium anodized frames and beadings complete with gaskets and seals. Colour to be selected.
 Tinted & Laminated 'Safety glass' 'Elior' to suite SANS strength and safety requirements, colour to be selected.
 Specialists to design, supply and install 'Nalup' Shofort Unit all to Architect's approval. Refer to Architectural Specifications for detail requirements.

QUANTITY: 2 off
 REFER TO LOCATION FOR LOCATION
 Powder coated 'Nalup' high grade quality Aluminium anodized frames and beadings complete with gaskets and seals. Colour to be selected.
 Tinted & Laminated 'Safety glass' 'Elior' to suite SANS strength and safety requirements, colour to be selected.
 Specialists to design, supply and install 'Nalup' Shofort Unit all to Architect's approval. Refer to Architectural Specifications for detail requirements.

QUANTITY: 2 off
 REFER TO LOCATION FOR LOCATION
 Powder coated 'Nalup' high grade quality Aluminium anodized frames and beadings complete with gaskets and seals. Colour to be selected.
 Tinted & Laminated 'Safety glass' 'Elior' to suite SANS strength and safety requirements, colour to be selected.
 Specialists to design, supply and install 'Nalup' Shofort Unit all to Architect's approval. Refer to Architectural Specifications for detail requirements.

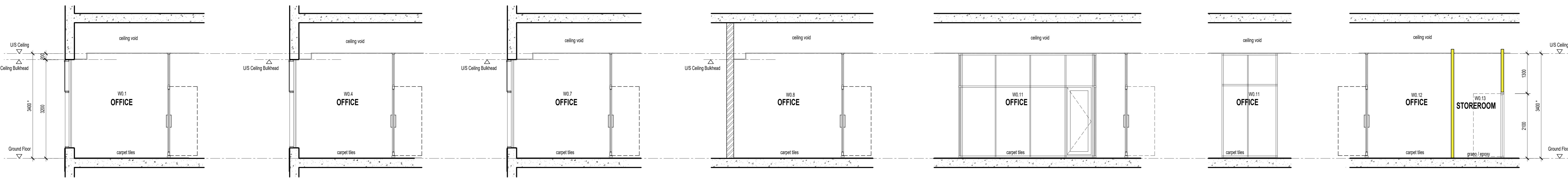

SEC LA-0001-07
SCALE 1:50

SEC LA-0001-08
SCALE 1:50

SEC LA-0001-09
SCALE 1:50

SEC LA-0001-010
SCALE 1:50

SEC LA-0001-011
SCALE 1:50

SEC LA-0001-012
SCALE 1:50

SEC LA-0001-013
SCALE 1:50

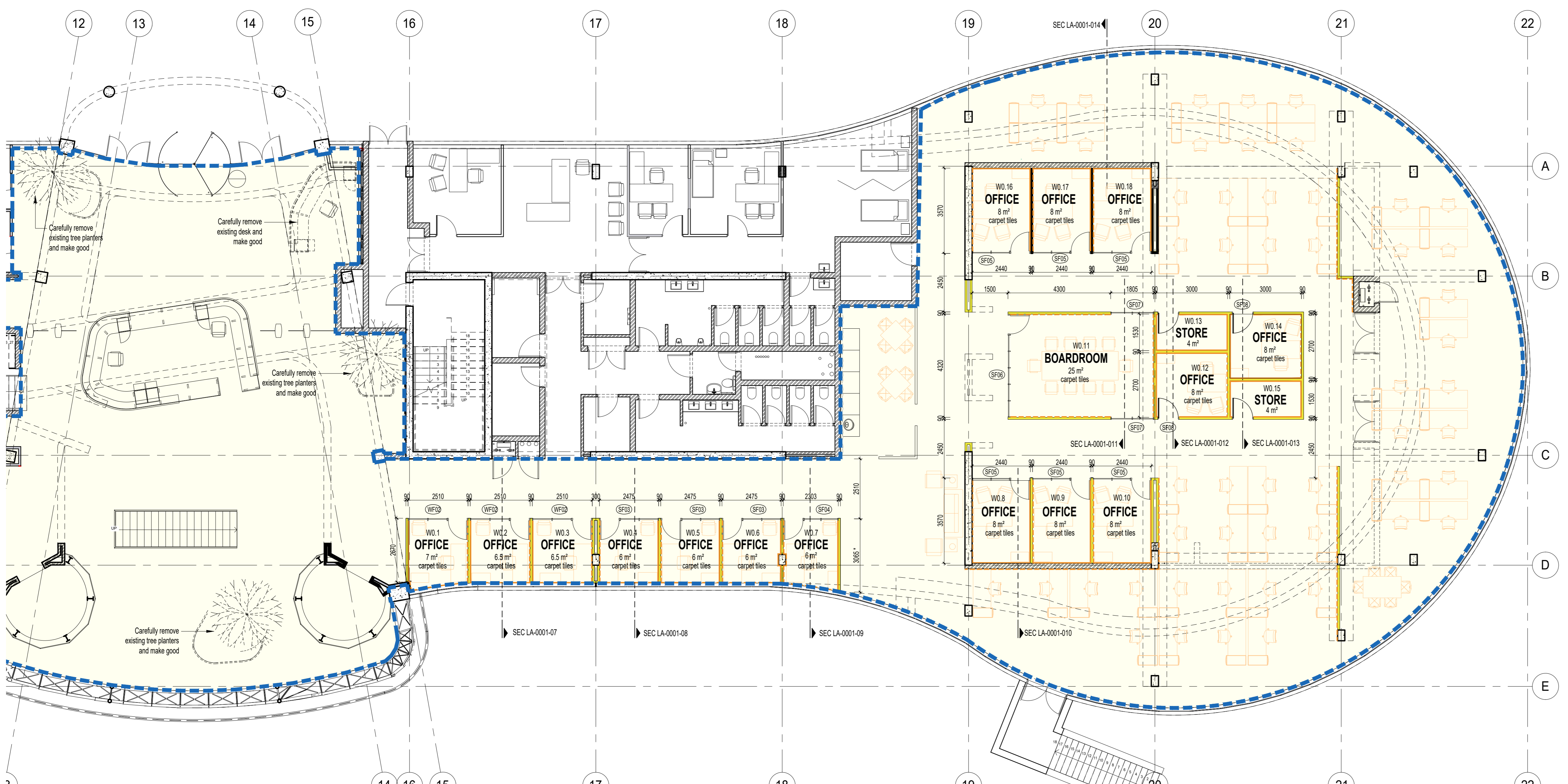

GROUND FLOOR 02
SCALE 1:100

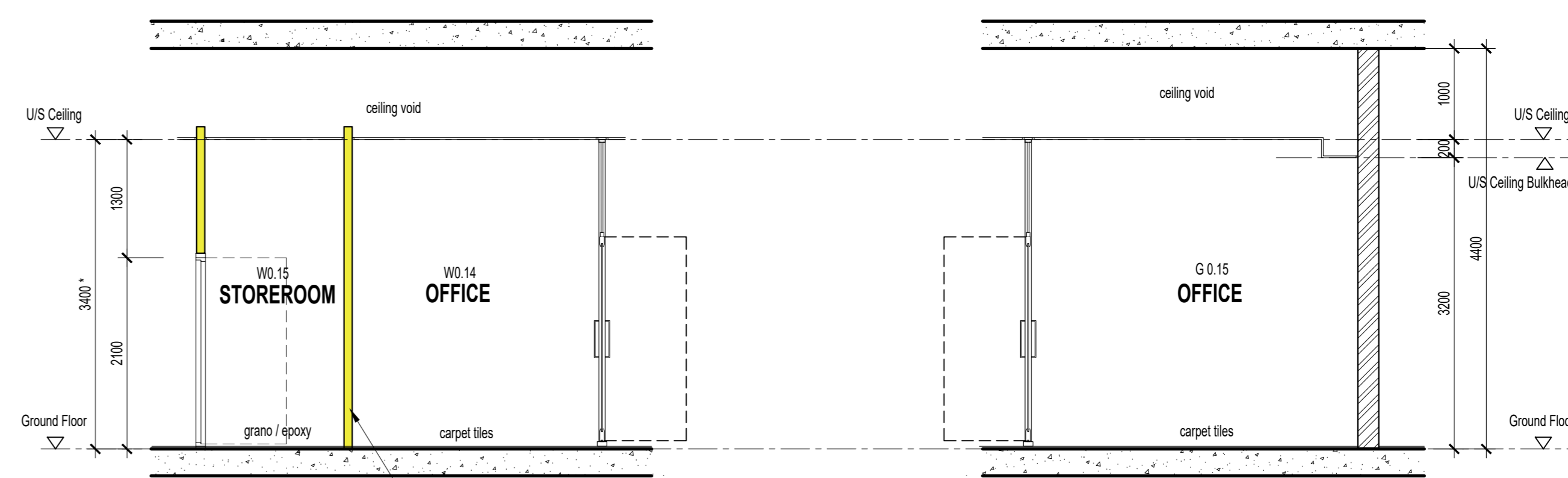

SEC LA-0001-014
SCALE 1:50

SEC LA-0001-015
SCALE 1:50

KEY LEGEND

- EXISTING WALL / COLUMN
- EXISTING WALL
- EXISTING PARTITION WALL
- PROPOSED PARTITION WALL
- WALL TO BE DEMOLISHED / REMOVED
- POWER SKIRTING (to match existing)
- SKIRTING (to match existing)
- DIMENSIONS (to be verified and confirmed on site)

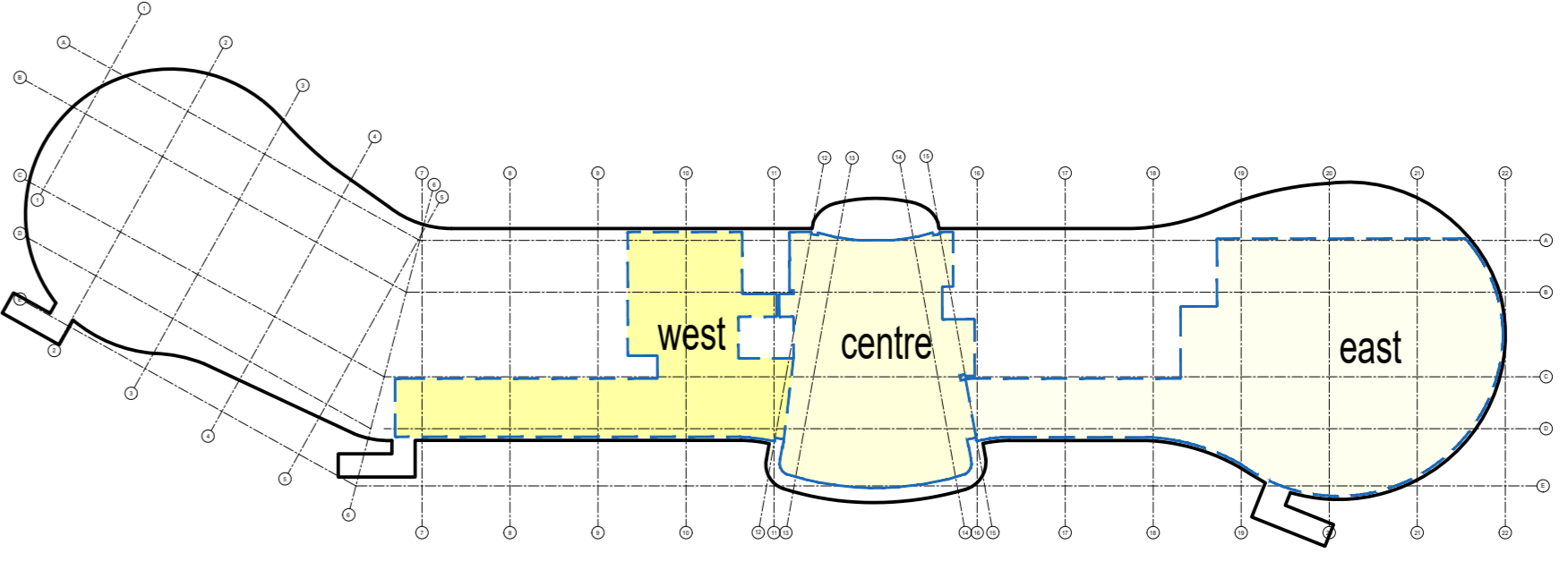

KEY PLAN

GENERAL NOTES

SCOPE OF WORKS
 General Building Contractor - the scope of work for general building contractor is to execute works as per building drawings and specification below. ICT - ICT equipment and infrastructure will be supplied and installed by a supplier appointed by ICT specialist.
 Furniture - Existing furniture will be retained any new furniture items will be procured by PM.

DOCUMENTS
 All work shall be executed in accordance with the requirements of SANS 10400, a copy of which shall be provided by Contractor and kept on site for the duration of the Contract. This Specification, any Supplementary Specifications and Drawings, shall be read in conjunction with and shall form part of the descriptions of items in the bills of quantities. Items described in the bills of quantities and not covered in these specifications or supplementary specifications shall be governed by the MODEL.
 PRESENTABLES FOR TRADES 2008' published by The Association of South African Quantity Surveyors, a copy of which shall be provided by the Contractor and kept on site for the duration of the Contract.
 In the event of conflicting specifications in the various documents, the following order of precedence shall prevail: 1st Bill of Quantities, 2nd This Specification, 3rd Supplementary Specifications, 4th Drawings, 5th MODEL PRESENTABLES FOR TRADES 2008. Reference to any documents or supplementary specifications shall be to its latest edition. For the purpose of this contract the term 'Principal Agent' in the MODEL PRESENTABLES FOR TRADES 2008 shall mean Project Manager or his official delegate.

MATERIALS
 All materials to be used shall be SABS approved unless otherwise stated.

WORKMANSHIP
 Workmanship must be the best in each trade and executed by competent, certified and registered Artisans, proof of which must be kept on site for duration of the Contract.

DIMENSIONS HEIGHTS AND LEVELS
 All Dimensions, Heights and Levels indicated on attached drawings and documentation are based on surface examination of the site. Drawings shall not be scaled but rather written dimensions shall be taken in preference. The Architect shall be approached for any missing dimensions, heights and levels.
 The Contractor shall verify written dimensions on site prior to the manufacture or preparation of installation items. Discrepancies and implications must be escalated to the Architect as soon as it is realized.

SET-OUT
 The Contractor shall timely set-out all aspects of the works, identify any conflicts or services and obtain the Supervisor's approval prior to commencing the works.

FIRE PROTECTION NOTES
 All work to comply with Act 103 of 1977 and SABS 0400 - 1990
 Occupancy Classification: G1
 a) 1 x 4.5 kg Extinguisher, per 200 m² of part thereof to be installed in accordance with SABS 3105
 Portable fire extinguishers to be hung on purpose made boards as indicated on plan.
 Escape doors may only be fitted with approved locking devices.
 Emergency lighting to be installed.
 b) Emergency route - Minimum 50 lux for a period of at least 60 minutes
 A manual actuated audible alarm in accordance with SABS 1530 to be installed.
 Photoluminescent escape signs to be provided and to comply with SABS 1186
 Prohibition sign, indicating fire equipment, to be provided and to comply with SABS 1186.
 Suspended ceiling and its supporting members shall be of non-combustible material.
 Structural elements and components shall have a minimum stability rating of 120 minutes.
 Stairing height not to exceed 3-metres.
 All doors leading to emergency route are class B fire doors.
 All fire escape routes, exits and fire fighting equipments to be clearly marked.

ENVIRONMENTAL HEALTH NOTES
 Office to be mechanically ventilated.
 Mechanical ventilation to comply with Part G of NBR.

NH - HARBOUR MASTER		NH - FINANCIAL MANAGER	
SIGNATURE	DATE	SIGNATURE	DATE
NH - RISK MANAGER		NH - ENVIRONMENTAL MANAGER	
SIGNATURE	DATE	SIGNATURE	DATE
NH - SECURITY MANAGER		NH - PROPERTY MANAGER	
SIGNATURE	DATE	SIGNATURE	DATE
NH - CORPORATE AFFAIRS MANAGER		NH - MARINE OPERATIONS MANAGER	
SIGNATURE	DATE	SIGNATURE	DATE
NH - MARKETING MANAGER		NH - CHIEF FIRE OFFICER	
SIGNATURE	DATE	SIGNATURE	DATE

Q1	ISSUED FOR PROCUREMENT	2023-02-07
Q2	ISSUED FOR APPROVAL	2012-10-15

No.	DESCRIPTION / REVISIONS	DATE
-----	-------------------------	------



PORT OF NGQURA
eMENDI BUILDING

DRAWING TITLE			
GROUND FLOOR AS-IS LAYOUT CURRENT SPACE USAGE			
DATE	2012-10-15	NO - DESIGN CENTRE MANAGER	
SCALE	AS SHOWN	SIGNATURE	DATE
DESIGNED BY	TA	NO - DEPUTY PORT ENGINEER	
CHECKED BY	LDP	SIGNATURE	DATE
DRAWN BY	TA	NO - PORT ENGINEER	
CHECKED BY	LDP	SIGNATURE	DATE
PAPER SIZE	TRANSNET DRW. NO.	SHEET REV.	
A0+	PoN-A0000-003-01		
CONSULTANT / CONTRACTOR DRW. NO.			
XH0E0006-1-200-A-LA-0002-01			